

INDUSTRIAL PRESSURE TRANSMITTER

Swiss based Trafag is a leading international supplier of high quality sensors and monitoring instruments for measurement of pressure and temperature. The economic pressure transmitter ECT 8473 is based on the tried and true ECT line of transmitters with the wide media temperature range from -25 to 125°C. The enhanced accuracy and the low pressure ranges down to 100 mbar in combination with a comprehensive set of features, materials and options makes the ECT 8473 pressure transmitter an ideal and versatile solution suitable for a wide variety of applications.



Applications

- Machine tools
- Hydraulics
- Water treatment

Features

- Economical
- Good media compatibility
- Relative or absolute pressure measurement
- Titanium version optional
- Frontal membrane optional

Technical Data			
Measuring principle	Thick film on ceramic	Accuracy @ 25°C typ.	± 0.3 % FS typ. (± 0.5 % FS typ., ± 1 % FS typ.)
Measuring range	0 ... 0.1 to 0 ... 40 bar 0 ... 1.5 to 0 ... 500 psi	Media temperature	-25°C ... +125°C
Output signal	4 ... 20 mA, 0 ... 5 VDC, 1 ... 6 VDC, 0 ... 10 VDC, 0.5 ... 4.5 VDC ratiom.	Ambient temperature	-25°C ... +85°C (Cable PVC 22: -5°C ... +60°C)

11/2016

Data sheet H72326u

Subject to change

ECT 0.3 % (0.5 %, 1.0 %) 8473

Ordering information/type code

				8473 .	XX	XX	XX	XX	XX
Measuring range ¹⁾	Pressure measurement range [bar]	Over pressure [bar]	Burst pressure [bar]						
	0 ... 0.1	1.2	2	66					
	0 ... 0.16	1.2	2	67					
	0 ... 0.2	1.2	2	68					
	0 ... 0.4	1.2	2	69					
	0 ... 0.6	2	3	70					
	0 ... 1.0	2	3	71					
	0 ... 1.6	3.2	4.8	73					
	0 ... 2.5	5	7.5	75					
	0 ... 4	8	12	76					
	0 ... 6	12	15	77					
	0 ... 10	20	25	78					
	0 ... 16	32	40	79					
	0 ... 25	50	75	80					
	0 ... 40	80	100	81					
	Pressure measurement range [ps]								
0 ... 1.5		15	30	F6					
0 ... 2		15	30	F7					
0 ... 2.5		15	30	F8					
0 ... 5		15	30	F9					
0 ... 7.5		30	45	G0					
0 ... 15		30	45	G1					
0 ... 20		40	60	G3					
0 ... 30		60	90	G5					
0 ... 50		100	150	G6					
0 ... 100		200	250	G7					
0 ... 150		300	375	G8					
0 ... 250		500	625	G9					
0 ... 400		800	1200	H0					
0 ... 500		1000	1250	H1					
Sensor		Relative pressure, 1.4305			54	Absolute pressure, 1.4305 ^{2) 3)}			
	Relative pressure, 1.4404/1.4435 ²⁾			56	Absolute pressure, 1.4404/1.4435 ^{2) 3)}				86
	Relative pressure, 1.4462 ²⁾			50	Absolute pressure, 1.4462 ^{2) 3)}				80
	Relative pressure, titanium grade 5 ²⁾			51	Absolute pressure, titanium grade 5 ^{2) 3)}				81
Pressure connection	G1/4" female								10
	G1/4" male								17
	G1/2" male ²⁾								21
	1/4" NPT male ²⁾								30
	G3/4" frontal membrane ^{2) 4)}								52
Electrical connection	Male electrical plug EN 175301-803-A, Mat. PA								05
	Male electrical plug M12x1, 5-pole, Mat. PA								35
	Male electrical plug industrial standard (contact distance 9.4 mm) Mat. PBT								01
	Male electrical plug Packard Metri Pack								51
	Cable IP67, Mat. PVC (cable gland PA6-3), -5°C ... +60°C ^{5) 6)}								22
	Cable IP68, max. 3m, medium +10°C...+35°C, Pmax. 1 bar rel./abs.								68
Output signal	Signal output	Load resistance	I (supply)	U (supply)					
	4 ... 20 mA	(U _{supply} -9 V) / 20 mA		9 ... 30 VDC					19
	0 ... 5 VDC	≥ 2.5 kΩ	≤ 10 mA	10 ... 30 VDC					14
	1 ... 6 VDC	≥ 5.0 kΩ	≤ 10 mA	10 ... 30 VDC					16
	0 ... 10 VDC	≥ 5.0 kΩ	≤ 10 mA	15 ... 30 VDC					17
	0.5 ... 4.5 VDC	≥ 5.0 kΩ	≤ 10 mA	5 VDC ± 0.25 VDC ratiom.					23

ECT 0.3 % (0.5 %, 1.0 %) 8473

8473 . XX XX XX XX XX XX

Accessories	Seal FKM (-20°C ... +125°C)	61
	Seal CR ≤ 100 bar (-25°C ... +100°C) ⁷⁾	62
	Seal EPDM (-25°C ... +125°C)	63
	Pressure peak damping element ø 1.0 mm (for pressure connections 17 and 30)	40
	Pressure peak damping element ø 0.3 mm (for pressure connections 17 and 30)	43
	Pressure peak damping element ø 0.5 mm (for pressure connections 17 and 30)	45
	Female electrical connector EN 175301-803-A (DIN43650-A)	58
	Female electrical plug M12x1, 5-pole	33
	Female electrical connector industrial standard	34
	Special electrical connection: Pin 1 + , Pin 2 - (only for output signal 4...20mA and male electrical plug EN175301-803-A / DIN43650-A)	92
	Special electrical connection: Pin 1 out , Pin 2 -, Pin 3 + (only for output 14, 16, 17, 23 and male electrical plug EN175301-803-A / DIN43650-A)	98
	Special electrical connection: Pin 1 + , Pin 2 -, Pin 3 out (only for output signals 14, 16, 17, 23 and male electrical plug EN175301-803-A / DIN43650-A)	97
	Special electrical connection: Pin 1 + , Pin 3 - (only for output 4...20 mA and male electrical plug Packard Metri Pack 3-poles)	E4
	Special electrical connection: Pin 1 + , Pin 2 out Pin 3 - (only for output signals 14, 16, 17, 23 and male electrical plug Packard Metri Pack 3-poles)	99
	Cable length 1.5 m	1M
	Cable length 3.0 m	3M
	Cable length 5.0 m	5M

¹⁾ Extended overpressure as well as customized pressure ranges upon request

²⁾ Please ask us

³⁾ Only for ranges: ≥ 400 mbar or 5 psi

⁴⁾ Not for sensors 54 and 84, only for pressure ranges ≤ 10 bar or 150 psi

⁵⁾ Cable length see accessories

⁶⁾ More materials and cables with venting tubes for low pressure ranges upon request

⁷⁾ Only for pressure connections 10 and 30



Identical construction for refrigeration:
Data sheet No. H72323

Standard products (extra short lead time)

Product No.	Type Code	Pressure range [bar]	Over pressure max. [bar]	Pressure connection	Signal output	Accuracy @ 25°C typ. [%]
ECT0.1A	8473 66 5417 05 0000 0000 19 58 61	0 ... 0.1	2	G1/4" male	4 ... 20 mA	1.0
ECT0.2A	8473 68 5417 05 0000 0000 19 58 61	0 ... 0.2	2	G1/4" male	4 ... 20 mA	0.5
ECT0.4A	8473 69 5417 05 0000 0000 19 58 61	0 ... 0.4	2	G1/4" male	4 ... 20 mA	0.5
ECT0.6A	8473 70 5417 05 0000 0000 19 58 61	0 ... 0.6	2	G1/4" male	4 ... 20 mA	0.3
ECT0.1V	8473 66 5417 05 0000 0000 17 58 61	0 ... 0.1	2	G1/4" male	0 ... 10 VDC	1.0
ECT0.2V	8473 68 5417 05 0000 0000 17 58 61	0 ... 0.2	2	G1/4" male	0 ... 10 VDC	0.5
ECT0.4V	8473 69 5417 05 0000 0000 17 58 61	0 ... 0.4	2	G1/4" male	0 ... 10 VDC	0.5
ECT0.6V	8473 70 5417 05 0000 0000 17 58 61	0 ... 0.6	2	G1/4" male	0 ... 10 VDC	0.3
ECTF0.1A	8473 66 5652 05 0000 0000 19 58 61	0 ... 0.1	2	G3/4" frontal membrane	4 ... 20 mA	1.0
ECTF0.2A	8473 68 5652 05 0000 0000 19 58 61	0 ... 0.2	2	G3/4" frontal membrane	4 ... 20 mA	0.5
ECTF0.4A	8473 69 5652 05 0000 0000 19 58 61	0 ... 0.4	2	G3/4" frontal membrane	4 ... 20 mA	0.5
ECTF0.6A	8473 70 5652 05 0000 0000 19 58 61	0 ... 0.6	2	G3/4" frontal membrane	4 ... 20 mA	0.3
ECTF1.0A	8473 71 5652 05 0000 0000 19 58 61	0 ... 1	2	G3/4" frontal membrane	4 ... 20 mA	0.3
ECTF1.6A	8473 73 5652 05 0000 0000 19 58 61	0 ... 1.6	3.2	G3/4" frontal membrane	4 ... 20 mA	0.3
ECTF2.5A	8473 75 5652 05 0000 0000 19 58 61	0 ... 2.5	5	G3/4" frontal membrane	4 ... 20 mA	0.3
ECTF4.0A	8473 76 5652 05 0000 0000 19 58 61	0 ... 4	8	G3/4" frontal membrane	4 ... 20 mA	0.3
ECTF6.0A	8473 77 5652 05 0000 0000 19 58 61	0 ... 6	12	G3/4" frontal membrane	4 ... 20 mA	0.3
ECTF10.0A	8473 78 5652 05 0000 0000 19 58 61	0 ... 10	20	G3/4" frontal membrane	4 ... 20 mA	0.3

ECT 0.3 % (0.5 %, 1.0 %) 8473

Specifications		
Electrical Data	Output / supply voltage	4 ... 20 mA: 24 (9 ... 30) VDC 0 ... 5 VDC: 24 (10 ... 30) VDC 1 ... 6 VDC: 24 (10 ... 30) VDC 0 ... 10 VDC: 24 (15 ... 30) VDC 0.5 ... 4.5 VDC: 5 VDC ratiom.
	Rise time	Typ. 1 ms / 10 ... 90 % nominal pressure
	Switch-on-delay	Max. 1.5 s
	Inverse-polarity protection, short-circuit strenght @ 25°C during 5 min.	4...20 mA: to $U_s = 30$ VDC 0...10 VDC, 0...5 VDC, 1...6 VDC: to $U_s = 30$ VDC 0.5...4.5 VDC ratiometric: to $U_s = 5.25$ VDC
	Environmental conditions	
	Media temperature	-25°C ... +125°C
	Ambient temperature	-25°C ... +85°C (Cable PVC 22: -5°C ... +60°C)
	Protection ¹⁾	IP65, IP67, IP68
	Humidity	Max. 95 % relative
	Vibration	4 g (10...2000 Hz)
	Shock	50 g / 8 ms
EMC Protection	Emission	EN/IEC 61000-6-3
	Immunity	EN/IEC 61000-6-2
Mechanical Data	Sensor (wetted parts)	Ceramic, Al ₂ O ₃ (96 %)
	Pressure connection (wetted parts)	54/84: 1.4305 (AISI303) 56/86: 1.4404/1.4435 (AISI316L) 50/80: 1.4462 (AISI318LN) 51/81: Titanium Grade 5
	Housing	54/84: 1.4305 (AISI303) 56/86: 1.4404/1.4435 (AISI316L) 50/80: 1.4462 (AISI318LN) 51/81: Titanium Grade 5
	Sealing	FKM 70 Sh, CR, EPDM
	Male electrical plug	See ordering information
	Weight	~ 110 g
	Mounting torque	15 ... 20 Nm

¹⁾ See electrical connection

Accuracy				
Pressure measuring range	[bar]	> 0 ... 0.4	0 ... 0.2	0 ... 0.1
	[psi]	> 0 ... 5	0 ... 0.4	0 ... 0.16
			0 ... 2.5	0 ... 1.5
			0 ... 5	0 ... 2
TEB @ -25...+85°C	[% FS typ.]	± 1.0	± 2.0	± 3.0
Accuracy @ +25°C	[% FS typ.]	± 0.3	± 0.5	± 1.0
NLH @ +25°C (BSL)	[% FS typ.]	± 0.2	± 0.3	± 0.3
TC zero point and span	[% FS/K typ.]	± 0.02	± 0.02	± 0.02
Long term stability 1 year @ +25°C	[% FS typ.]	± 0.2	± 0.2	± 0.2

Measuring accuracy 1.0 %

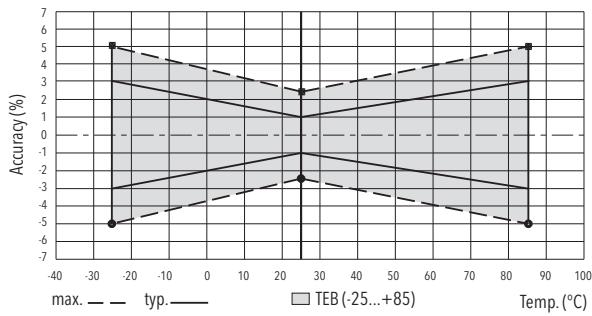

Measuring accuracy 0.5 %

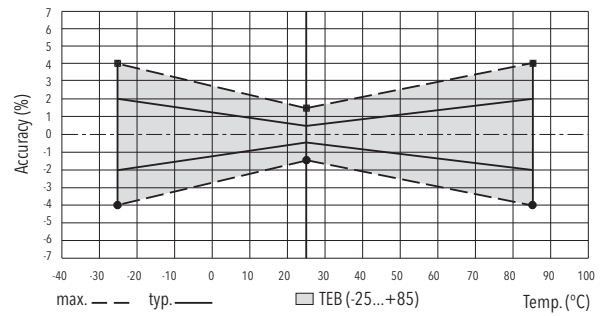

Measuring accuracy 0.3 %

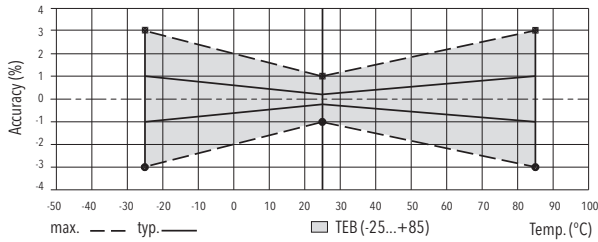

Electrical Connection

		Protection / electrical connection				
		IP65*)	IP67/IP68 max. 3m	IP67*)	IP67*)	IP65
		Industrial standard EN175301-803A **)	Cable**) 22/68	M12x1 **) 5-pole 35	Packard Metri Pack **) 3-pole 51	Industrial standard Contact distance 9.4 mm **) 01
Output signal	<p>8473.xx.xxxx.xx.19</p>	Standard	92			E4
	<p>8473.xx.xxxx.xx.14/16/17/23</p>	Standard	98 97			99
		2	3	1	1	1
		1	2	2	2	2
		⊕	⊕	⊕	⊕	⊕
		white		white		white
		brown		green		green
		⊕		brown		brown
		⊕		⊕		⊕
		4		2		1
		1		3		2
		5		5		3
		⊕		⊕		⊕

- *) Provided female connector is mounted according to instructions
- **) Ventilation via male electric plug/cable end
- ***) Only cable versions or female plug with shield connection

Additional information

Documents

Data sheet	www.trafag.com/H72326
Instructions	www.trafag.com/H73324
Flyer	www.trafag.com/H70663

ECT 0.3 % (0.5 %, 1.0 %) 8473

Dimensions

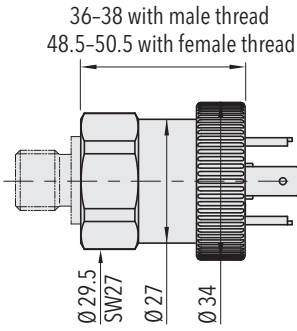

8473.XX.XXXX.05.XX.XX

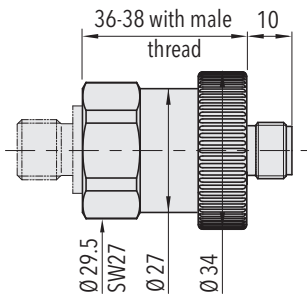

8473.XX.XXXX.35.XX.XX

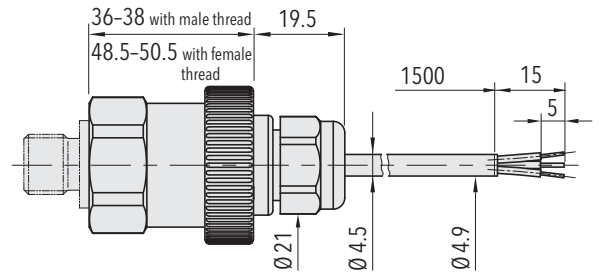

8473.XX.XXXX.22/68.XX.XX

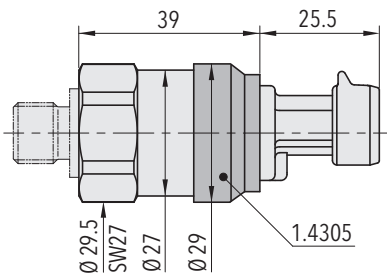

8473.XX.XXXX.51.XX.XX

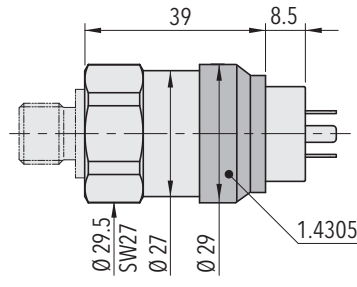

8473.XX.XXXX.01.XX.XX

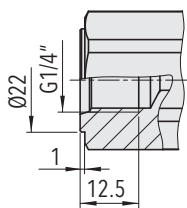

8473.XX.XX10.XX.XX.XX

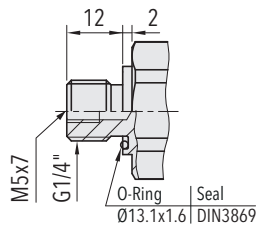

8473.XX.XX17.XX.XX.XX

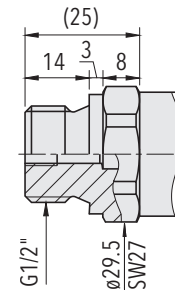

8473.XX.XX21.XX.XX.XX

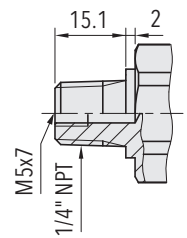

8473.XX.XX30.XX.XX.XX

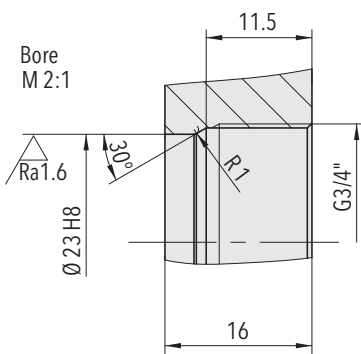

8473.XX.XX52.XX.XX.XX

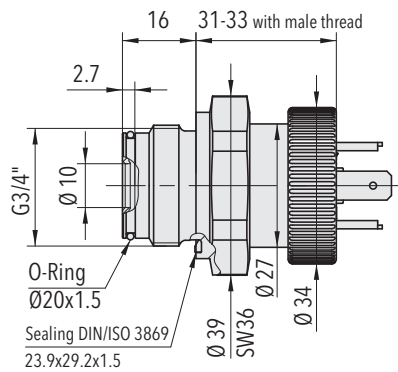

8473.XX.XXXX.XX.XX.33

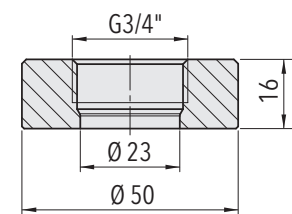

Welding flange for G3/4" frontal membrane (1.4301)
Ordering No. C27805

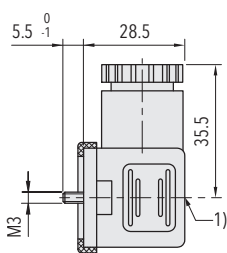

1) Tightening torque 50...60Ncm

8473.XX.XXXX.XX.XX.58

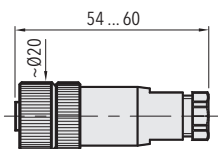

8473.XX.XXXX.XX.XX.33

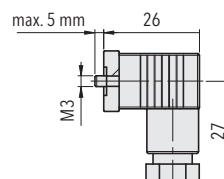

8473.XX.XXXX.XX.XX.34